

PRECISION SPINE

REFORM[®]

POCT SYSTEM

SIMPLE, COMPREHENSIVE SOLUTION

The Reform[®] POCT System is a simple, comprehensive solution for fusion of the Occipital region of the spine and can be used in conjunction with the SureLOK[™] PC Posterior Cervical System. Two plate footprints allow midline fixation in the areas of greatest bone thickness. Both plates offer lateral points of rod fixation and feature multiple contour zones ensuring optimal anatomical fit. The total freedom tulip design (10mm of translation, $\pm 30^\circ$ of rotation & $\pm 15^\circ$ of cephalad/caudal angulation) allows for easier occipital cervical junction alignment by minimizing rod contouring.

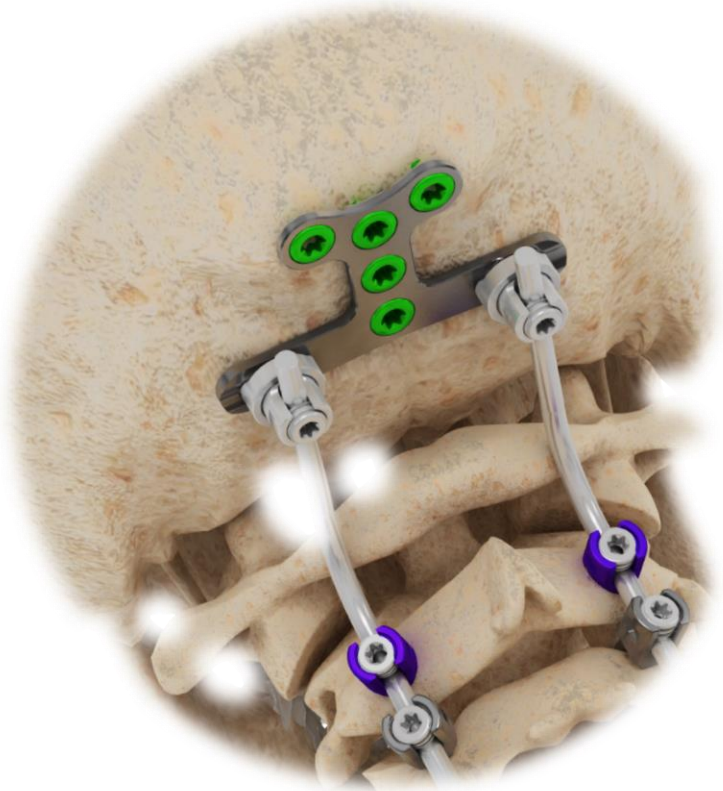

OPTIMAL ANATOMICAL FIT



CONTOUR ZONES

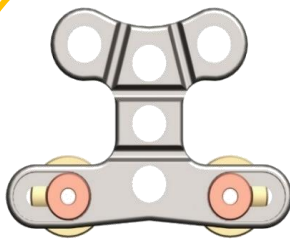

TOTAL FREEDOM TULIP

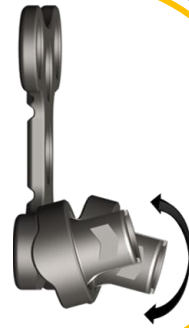

REFORM® POCT SYSTEM



Y-shape and A-shape plate footprints with Midline Fixation provide optimal placement in areas of greatest bone thickness. Plates are offered in small, medium and large sizes.

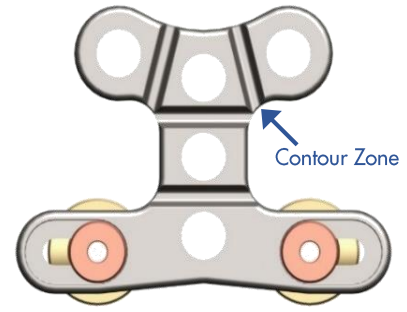

Contour Zones provide better bone-plate interface for more stable fixation.

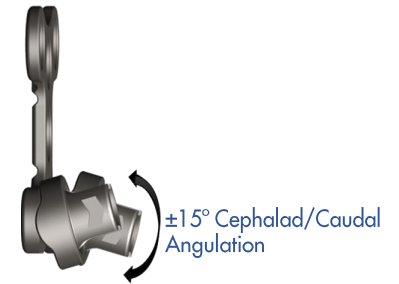
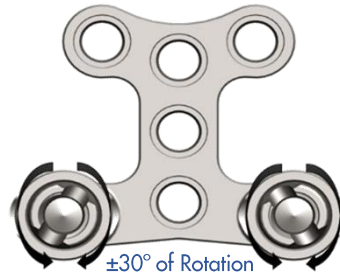
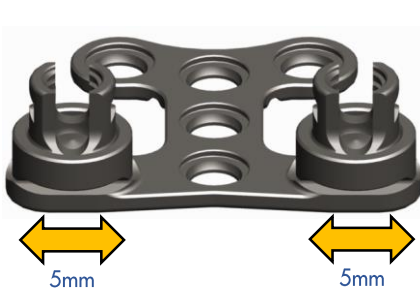

The total freedom tulip allows for easier connection across the occipital cervical junction by minimizing rod contouring through offering 10mm of translation, $\pm 30^\circ$ of rotation, and $\pm 15^\circ$ of cephalad/caudal angulation.

Screw Sizes

Screw Diameter	Screw Lengths	Insertion Angulation
4.50mm	6-16mm (2mm incr.)	$\pm 10^\circ$
5.25mm	6-16mm (2mm incr.)	$\pm 10^\circ$

Plate Sizes

Description	Size
Small	25-35mm
Medium	32-42mm
Large	40-50mm

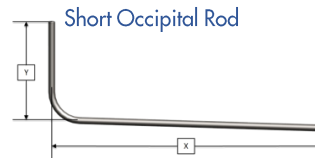

ø3.5mm – Rod Sizes

Length (Y,X)	Available Rod Options	Material Composition
240mm	Straight	Ti
240mm	Straight	CoCr
51mm x 127mm	75° Pre-Lordosed	Ti
51mm x 127mm	75° Pre-Lordosed	CoCr
51mm x 127mm	90° Pre-Lordosed	Ti
51mm x 127mm	90° Pre-Lordosed	CoCr
127mm x 127mm	75° Pre-Lordosed	Ti
127mm x 127mm	75° Pre-Lordosed	CoCr
127mm x 127mm	90° Pre-Lordosed	Ti
127mm x 127mm	90° Pre-Lordosed	CoCr

*Red denotes Special Order Only

Precision Spine, Inc.

2050 Executive Drive, Pearl, MS 39208
 Customer Service: 1.888.241.4773
 Phone: 601.420.4244
 Toll Free: 877.780.4370
 Fax: 601.420.5501
 www.precisionspineinc.com

